

Expansion vessels

PRODUCT SHEET



FEATURES

Model		HWB 8LX	HWB 12LX	HWB 18LX
Characteristics	Nominal volume	8 L	12 L	18 L
	Maximum temperature	99°C		
	Maximum working pressure	6 bar		
	Factory pre-load	0,7 bar		
	Connections	Carbon steel 3/4" BSP F		
Dimensions and packaging	A (Height)	30,95 cm	36,40 cm	36,40 cm
	B (Width)	20,20 cm	23 cm	27,90 cm
	Packaging weight	2 kg	2,70 kg	3,40 kg
	Packaging volume	0,016 m ³	0,023 m ³	0,029 m ³
	Units per palet	108	90	56

Expansion vessels for thermal expansion of heating hydronic systems.

For the installation in closed heating circuits and cannot be used for domestic hot water (vessels lack internal lining).

Suitable for use of propylene glycol up to mixing concentrations of 50%. Ethylene glycols should be avoided at all costs.

Features

- Air chamber sealed with a bronze air valve and a ring seal on the cover.
- Exterior finish with polyurethane paint with epoxy base, resistant to the most aggressive conditions (outdoor or indoor installation).
- Designed and manufactured according to 2014/68/UE Directive.

Wall installation bracket kit with adjustable flange model BR3 UNIVERSAL available (not included).

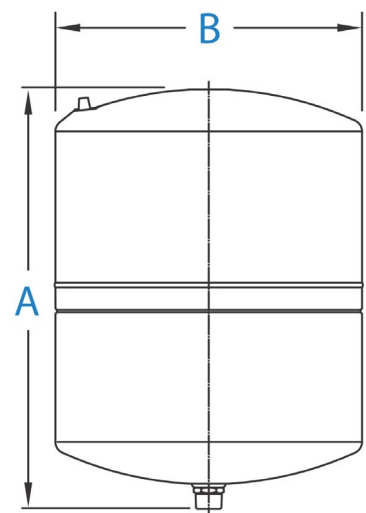

NOTES:

(1) The data and specifications present in this sheet may vary without notice.

(2) The images on this sheet are indicative and may be different from the final machine.